

910-620 TORONTO ST

VICTORIA, B.C.



2 BEDROOMS



1 BATHROOM



797 SQ FT

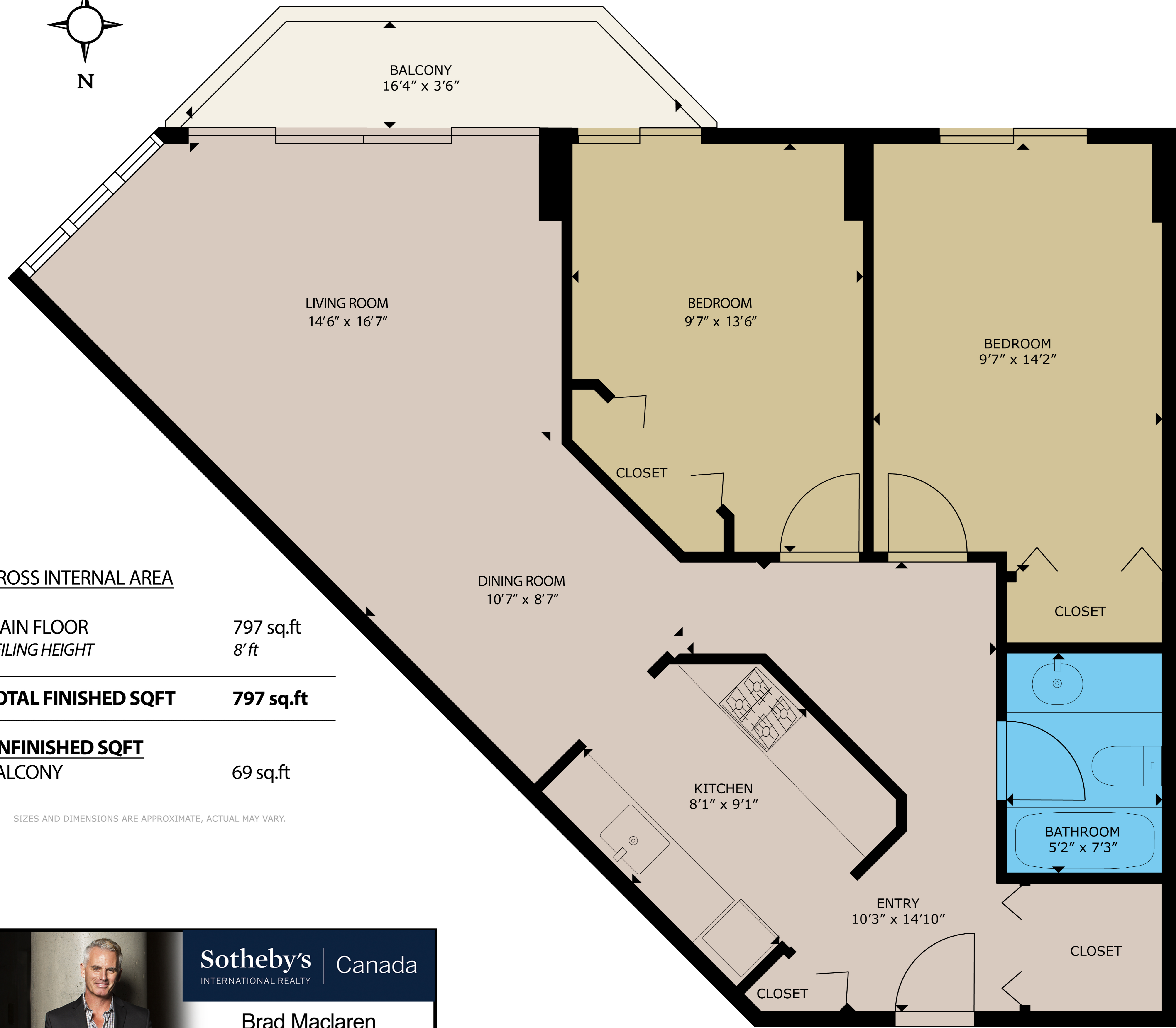
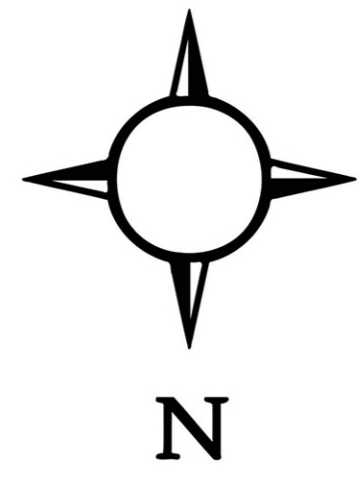

GROSS INTERNAL AREA

MAIN FLOOR 797 sq.ft
CEILING HEIGHT 8' ft

TOTAL FINISHED SQFT 797 sq.ft

UNFINISHED SQFT 69 sq.ft
BALCONY

SIZES AND DIMENSIONS ARE APPROXIMATE, ACTUAL MAY VARY.



Sotheby's | Canada
INTERNATIONAL REALTY

Brad Maclaren
250.727.5488
www.bradmaclaren.com

PREPARED FOR THE EXCLUSIVE USE OF
BRAD MACLAREN PREC*

FLOOR PLAN